

How to delete CS Registration

(KX-UDS/UDT series)

No. 41-005

August 21 , 2012

Ver.1.0

Panasonic Corporation

Abstract about this document

This document describe about how to delete CS Registration.

Revision history

Date	Version	Revision	Firmware version
Aug. 21, 2012	Ver. 1.0	Initial Release	All versions

Procedure

<Step1> Confirm IP address of Super Master CS



<Step2> Open the CS Web port



<Step3> Delete CS Registration

<Step1> How to confirm IP Address of Super Master CS

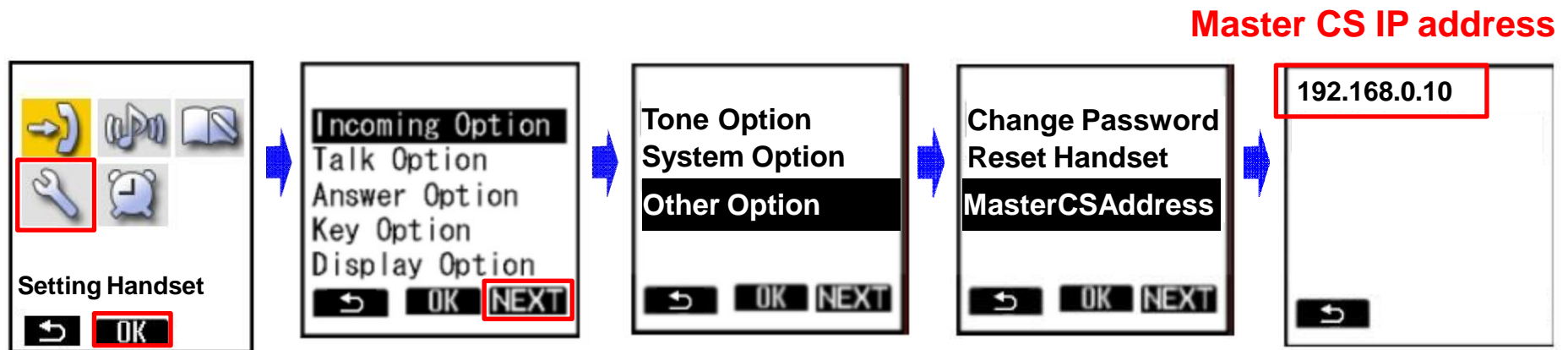

1. Turn on the PS.
2. Press [Menu] or the [CENTER] navigation key.
3. Select **"Setting Handset"** and then press [OK].
4. Press [NEXT].
5. Select **"Other Option"** and then press [OK].
6. Select **"MasterCSAddress"** and the press [OK].
 - Display the Master CS IP address.

<Step2> How to Open the CS Web port

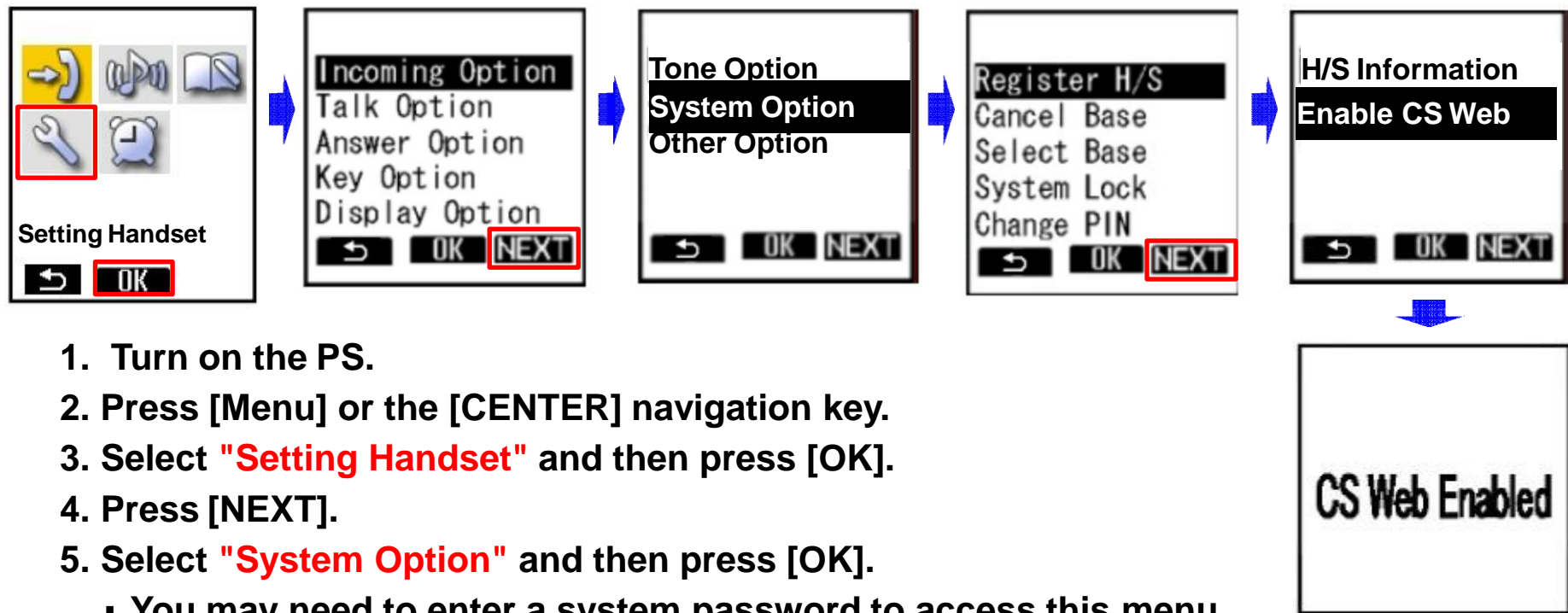

1. Turn on the PS.
2. Press [Menu] or the [CENTER] navigation key.
3. Select **"Setting Handset"** and then press [OK].
4. Press [NEXT].
5. Select **"System Option"** and then press [OK].
 - You may need to enter a system password to access this menu.
6. Press [NEXT] to display the second screen, select **"Enable CS Web"**, and then press [OK].
7. When the operation is complete, "CS Web Enabled" is displayed.

<Step3> How to delete CS Registration

CS Management

Air Sync Group: 1

CS Registration Start / Stop: Start CS Registration / Stop CS Registration

Only CS that has a check in the check box can be deleted.

CS Registration Delete: Delete CS Registration

CS Registered List

No.	Index	CS Name CS ID	MAC Address IP Address	CS Class	Remote Login
1	1	0018E73800	00.80.F0.F0.6C.78 192.168.0.103	Master	
2	2	0018E73700	00.80.F0.F0.6C.79 192.168.0.102	Slave	Login
3	3	0018E6D600	00.80.F0.E9.76.33 192.168.0.104	Slave	Login

1. Log in to the Super Master CS.
2. In the [System] tab, select [CS Management].
[System] → [CS Management]
3. Select the CS which you want to delete and click to check the box.
4. Click [Delete CS Registration].
5. Click [OK].
 - The CS which you select are cleared in “CS Registered List”.

ID and Password for administrator
 ID : admin
 Password : adminpass

Notice

After deleting, the CS which you select reboots automatically.